

alled Norleans)

Agreement required with the Highways Department for the temporary re-routing of pedestrians during demolition of office gable and realignment of stone walls (visibility splay)

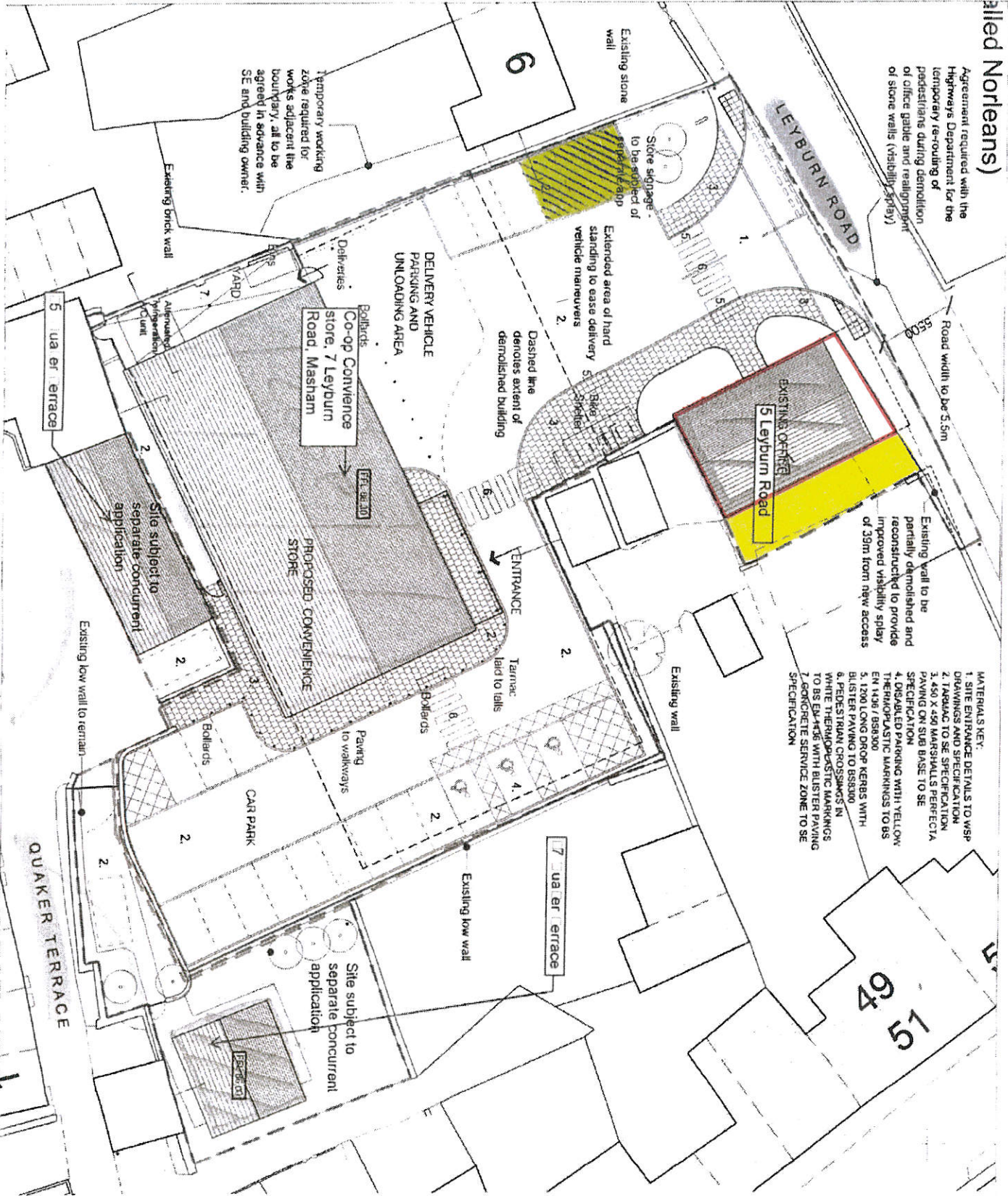

- MATERIALS KEY:**
- 1 SITE ENTRANCE DETAILS TO WSP DRAWINGS AND SPECIFICATION
 - 2 TARMAC TO SE SPECIFICATION
 - 3 450 X 450 MARSHALLS PERFECTA PAVING ON SUB-BASE TO SE SPECIFICATION
 - 4 DISABLED PARKING WITH YELLOW THERMOPLASTIC MARKINGS TO BS EN 4201 BS8300
 - 5 1200 LONG DROW KERBS WITH BULSTER PAVING TO BS8300
 - 6 PEDESTRIAN CROSSINGS IN WHITE THERMOPLASTIC MARKINGS TO BS EN 4201 WITH BULSTER PAVING
 - 7 CONCRETE SERVICE ZONE TO SE SPECIFICATION

- 1 SITE ENTRANCE DETAILS TO WSP DRAWINGS AND SPECIFICATION
- 2 TARMAC TO SE SPECIFICATION
- 3 450 X 450 MARSHALLS PERFECTA PAVING ON SUB-BASE TO SE SPECIFICATION
- 4 DISABLED PARKING WITH YELLOW THERMOPLASTIC MARKINGS TO BS EN 4201 BS8300
- 5 1200 LONG DROW KERBS WITH BULSTER PAVING TO BS8300
- 6 PEDESTRIAN CROSSINGS IN WHITE THERMOPLASTIC MARKINGS TO BS EN 4201 WITH BULSTER PAVING
- 7 CONCRETE SERVICE ZONE TO SE SPECIFICATION



SITE BOUNDARY

ADJACENT SITE OWNERSHIP

This plan has been prepared from a survey of the site and its surroundings. It is intended to show the proposed layout of the site and its surroundings. It is not intended to show the boundaries of the site or its surroundings. It is not intended to show the boundaries of the site or its surroundings.

PLAN 1

Project Name	New Convenience Store
Client	W. E. Jamison & Son Ltd
Proposed site plan	Showing site boundary
Scale	1:250 @ A3
Date	Jan 2010
Author	AW
Check	AW
Drawn	AW
Project No.	080177A, 103
Sheet No.	N