



AVAILABLE TO LET

# Sovereign Park, Park Royal

Coronation Road, Park Royal, London, Greater London, NW10 7QP

## 47,113 SQ FT | PARK ROYAL | FULLY FITTED | MODERN | OPERATIONAL | STORAGE & DISTRIBUTION FACILITY

<b>Rent</b>	£300,000 pa (Passing)
<b>Est. rates payable</b>	£3.35 psf £164,896 pa
<b>Rateable value</b>	£317,500
<b>UBR 2016/2017</b>	49.7
<b>Building type</b>	Industrial
<b>Planning class</b>	B8
<b>Sizes</b>	38,674 sq ft to 47,113 sq ft
<b>Premium</b>	Offers invited
<b>Lease type</b>	Assignment
<b>EPC Category</b>	C
<b>EPC</b>	Available on request

Marketed by: The Lorenz Consultancy

For more information please visit:  
<https://realla.co/m/4831-sovereign-park-park-royal-coronation-road>





Sovereign Park, Park Royal, Coronation Road, Park Royal, London, Greater London, NW10 7QP

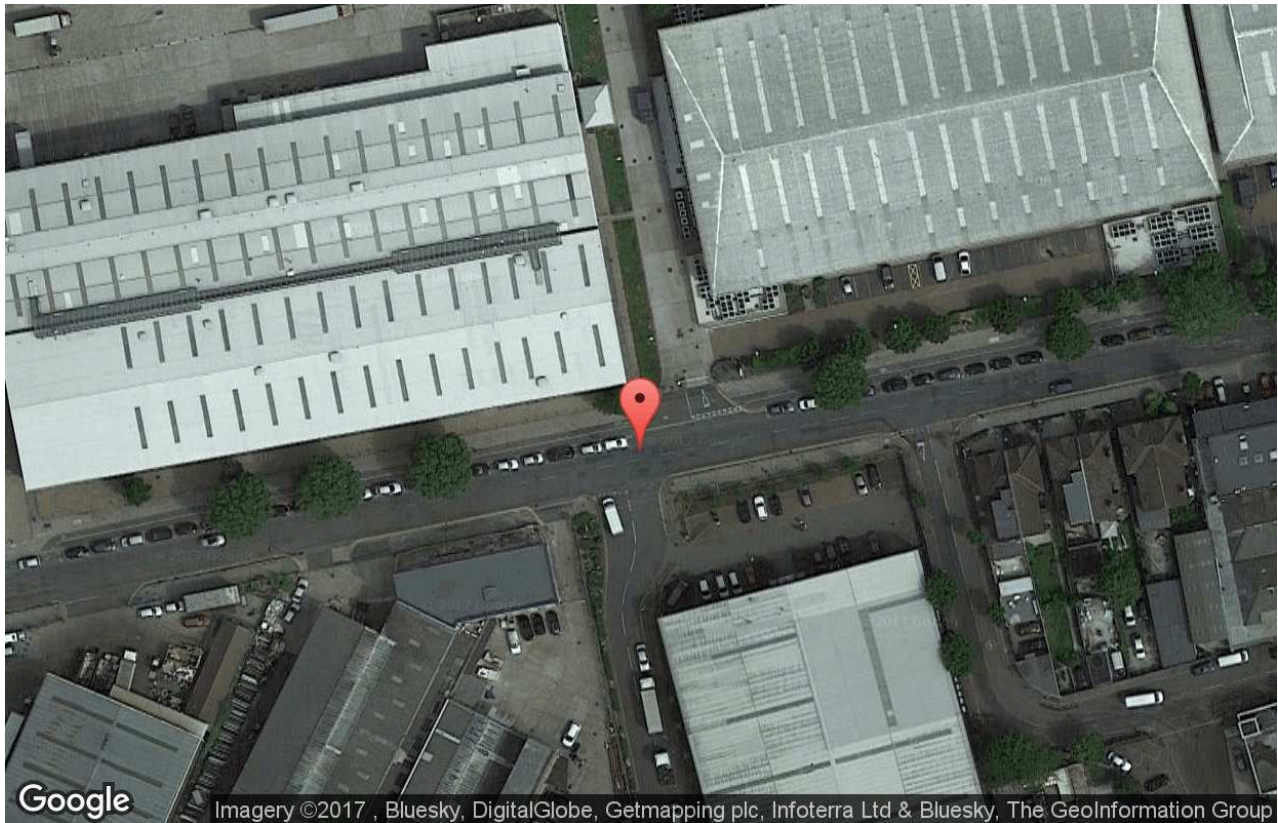

Data provided by Google

Floor	Sq ft	Sq m
Ground Warehouse	23,185	2,153.96
Ground Offices	4,499	417.97
1st Floor Warehouse (Permanent Mezz)	6,426	597.0
1st Floor Offices	4,564	424.01
1st Floor Temp Mezz	4,951	459.96
1st Floor Temp Mezz	3,488	324.05
<b>Total size</b>	<b>47,113</b>	<b>4,376.95</b>

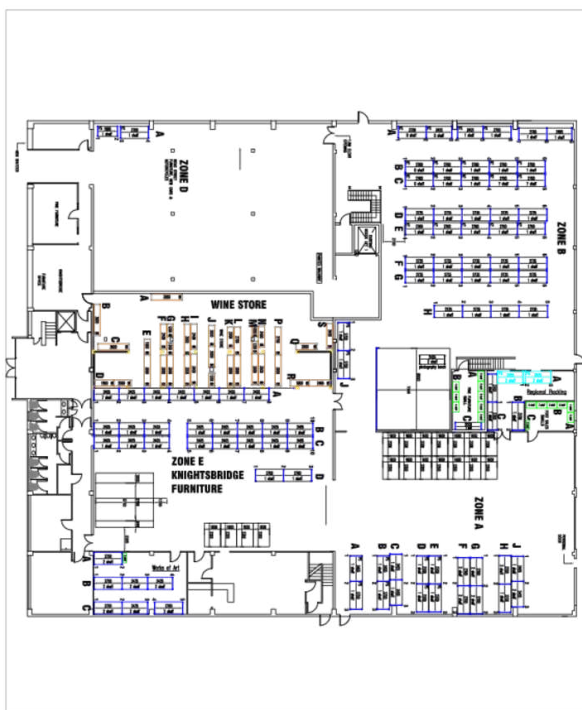

THE LORENZ CONSULTANCY LTD
   
 100 Park Royal
   
 Park Royal
   
 Uxbridge
   
 Middlesex
   
 Ux8 9PL
   
 UK
   
 Tel: +44 (0)1895 836100
   
 Fax: +44 (0)1895 836101
   
 Email: info@lorenz.co.uk
   
 Website: www.lorenz.co.uk
   
 CHESTERFIELD
   
 100 Park Royal
   
 Park Royal
   
 Uxbridge
   
 Middlesex
   
 Ux8 9PL
   
 UK
   
 Tel: +44 (0)1895 836100
   
 Fax: +44 (0)1895 836101
   
 Email: info@lorenz.co.uk
   
 Website: www.lorenz.co.uk

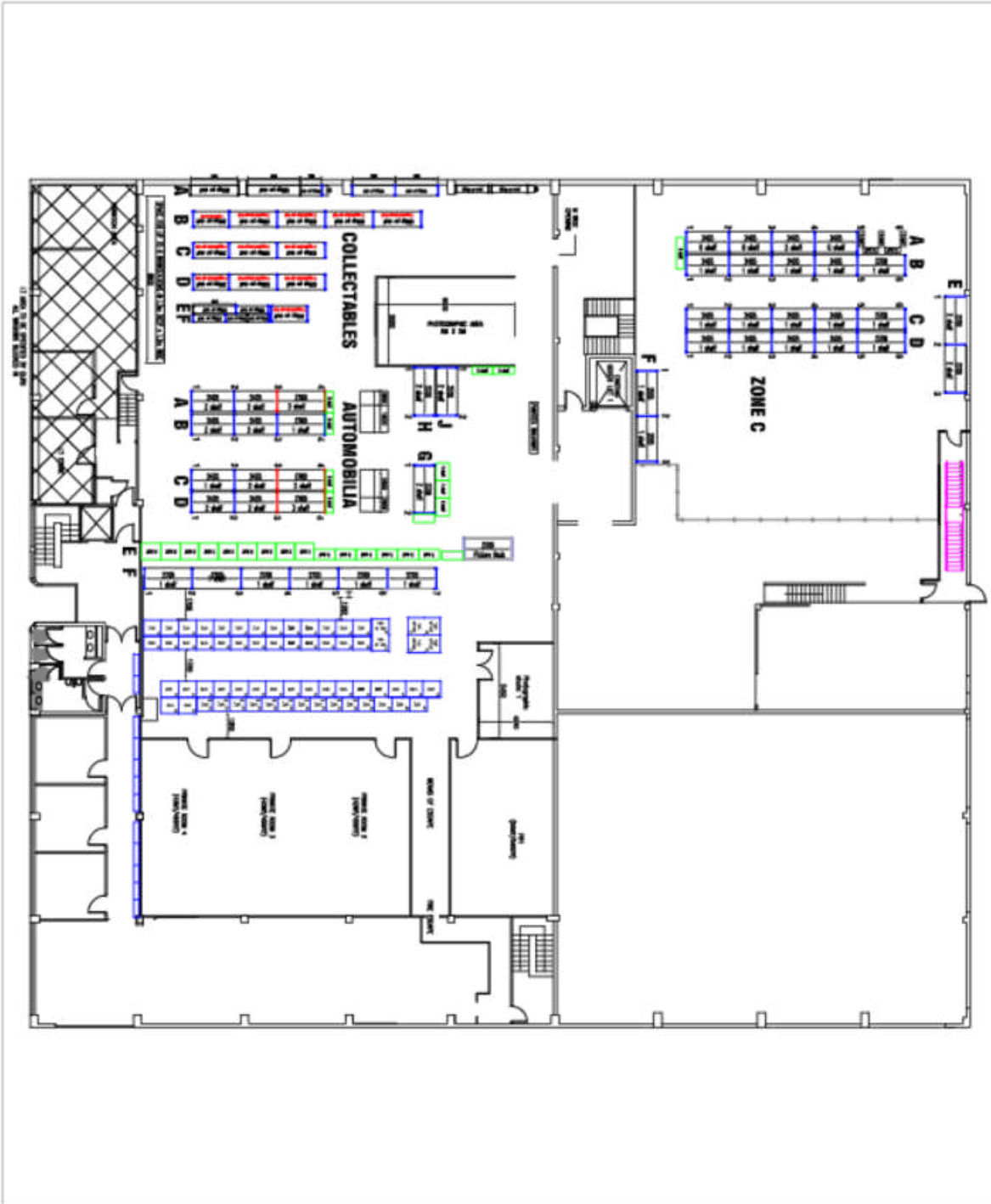

101 PERIMETER SERVICE LAM 2017  
 Copyright: Epsilon Light and  
 all other Rights Reserved

This drawing is the property of Epsilon Light and is  
 intended for use only for the project specified.  
 The information contained herein is confidential and  
 intended for use only for the project specified.  
 No part of this drawing may be reproduced, stored in a  
 retrieval system, or transmitted in any form or by any  
 means, electronic, mechanical, photocopying, recording,  
 or by any information storage and retrieval system, without  
 the prior written permission of Epsilon Light and its  
 subsidiaries.

**NOTES:**  
 ALL DIMENSIONS IN MILLIMETERS  
 UNLESS OTHERWISE SPECIFIED

**PENNYLIGHT LTD**  
 101 PERIMETER SERVICE LAM  
 101 PERIMETER SERVICE LAM  
 101 PERIMETER SERVICE LAM  
 101 PERIMETER SERVICE LAM

**OEXION**  
 Client: Bonhams  
 Job Title: Park Royal  
 1st Floor  
 Rev: 01  
 No: 1129

---

<b>Airports</b>	London Heathrow 8.7m, London City 14.3m, London Luton 24.2m
<b>National rail</b>	Acton Main Line 0.9m, Stonebridge Park 1.1m, Harlesden 0.9m
<b>Tube</b>	Park Royal 0.4m, West Acton 0.8m, Acton 0.9m
<b>Technical spec.</b>	Site area 1.23 acres
<b>Estimated rates</b>	£164,895.50 pa £3.35 psf
<b>Planning class</b>	B8
<b>EPC</b>	Available on request

Notes:

---

---

---

---

---



(0) 207 629 9898  
info@lorenzconsultancy.com

The Lorenz Consultancy



**Andrew Knights**

02076474043  
07825742853  
ak@lorenzconsultancy.com

The Lorenz Consultancy



**Anthony Epenetos**

0207 647 4042  
0791 787 8404  
ae@lorenzconsultancy.com

The Lorenz Consultancy



**Bailey Crouch**

02076474049  
02076299898  
bc@lorenzconsultancy.com

The Lorenz Consultancy Limited. Registered Office: Lynton House, 7-12 Tavistock Square, London WC1H 9BQ, registered in England and Wales No. 06641570. This communication is from The Lorenz Consultancy Limited. This communication contains information which is confidential and may be privileged. If you are not the intended recipient, please contact the sender immediately. Any use of its contents is strictly prohibited and you must not copy, send or disclose it, or rely on its contents in any way whatsoever. Reasonable care has been taken to ensure that this communication (and any attachments or hyperlinks contained within it) is free from computer viruses. No responsibility is accepted by The Lorenz Consultancy Limited and the recipient should carry out any appropriate virus checks. All offers are made subject to contract and all statements are made without prejudice.