

Last  
Available Unit



# centralpark

Western Avenue, Bridgend Industrial Estate  
Bridgend, Mid Glamorgan CF31 3TY

## Trade Counter End Unit To Let



- Strategic Location close to M4 (J35)
- High Quality Accommodation
- 6m Eaves Height
- Unit 2300 - 327 sqm (3,519 sqft)





# centralpark

## The Estate

Central Park is situated within the heart of Bridgend Industrial Estate, halfway between Cardiff and Swansea and near to the M4 at Junction 35. Close to Bridgend town centre and yet within easy reach of the motorway, Central Park is easily accessible for employees and customers.

The Estate is a popular location for commercial/trade counter users such as Biotec, Screw Fix, Plumbase, Toolstation, Edmundson Electrical & Greggs

## Accommodation

Accommodation available is as follows (all areas are on an approximate gross internal basis):

Unit no.	sqft	sqm
2300	327	3,519

## Terms

The property is available to let on a full repairing and insuring lease.

## Specification

- High quality trade counter units
- 6m eaves height
- Steel portal frame
- 37.5 kN/m<sup>2</sup> floor loading
- Mains services connected
- EPC - D

## Contact

For further information or to arrange a viewing, please contact the joint agents, details below.

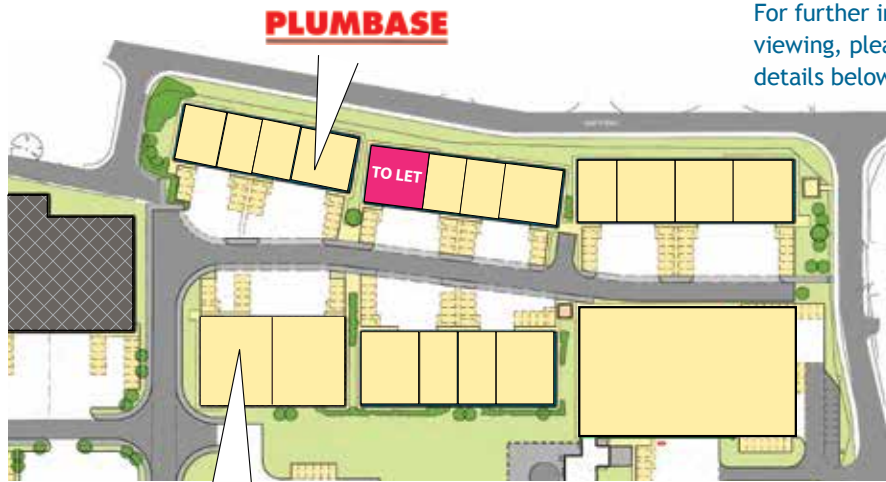

For illustration purposes only

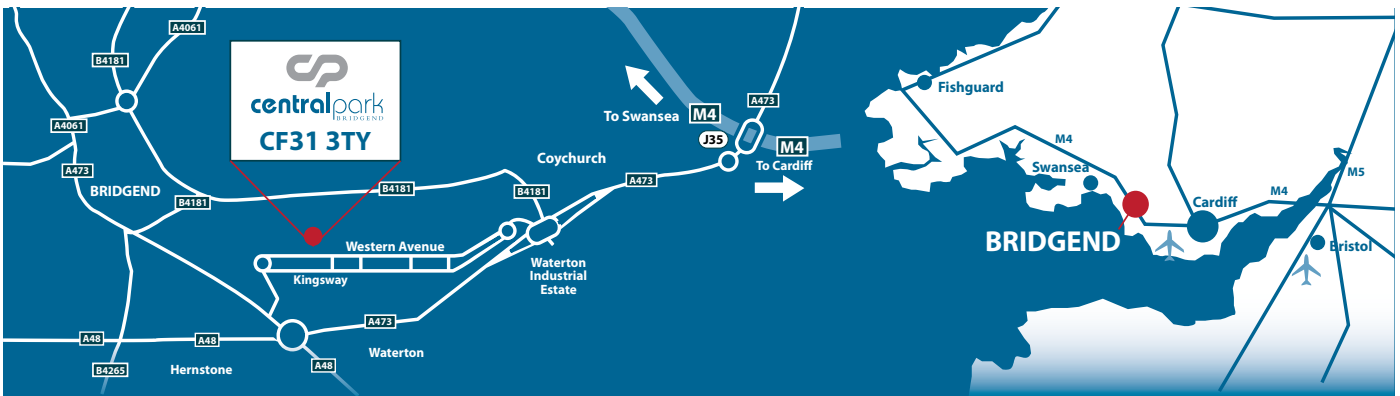

Viewing by appointment with joint agents:

**Knight Frank**  
Cardiff  
029 2049 2492  
KnightFrank.co.uk

neil.francis@knightfrank.com

**Lambert Smith Hampton**  
029 2049 0499  
www.lsh.co.uk

rtamplin@lsh.co.uk



**Robert Hitchens**  
The Complete Development Solution

**01242 680694**  
www.robert-hitchens.co.uk

Robert Hitchens Limited for themselves and any of their Agents give notice that: a) these particulars are prepared for the convenience of an intending purchaser or tenant and although they are believed to be correct their accuracy is not guaranteed and any error, omission or mis-description shall not annul a sale or lease or be grounds on which compensation may be claimed neither do they constitute part of a contract. All measurements are approximate. b) any intending purchaser or tenant must satisfy himself by inspection or otherwise as to the correctness of each of the statements contained in these particulars. Nothing in this information shall be deemed a statement that a property is in good condition or otherwise nor that any services or facilities are in good working order. c) all transactions are subject to contract. d) all text, photographs and plans are for guidance only and must not be relied upon as statements of fact.